

NOTES:
 (1) A TOP OF E.O.L. TO BE COINED WITH IRREGULARITY COATING OF STEEL AND ONLY IN REDNESS.
 (2) A TO BE KEPT CLOSED AT THE SEA AND A PERMANENT INDEX TO THIS EFFECT SHALL BE POSTED ON EITHER SIDE OF THE DOOR.
 MW = MAINWATER TANK DOOR
 MWI = MAINWATER TANK INCH
 WT = WATER TANK DOOR

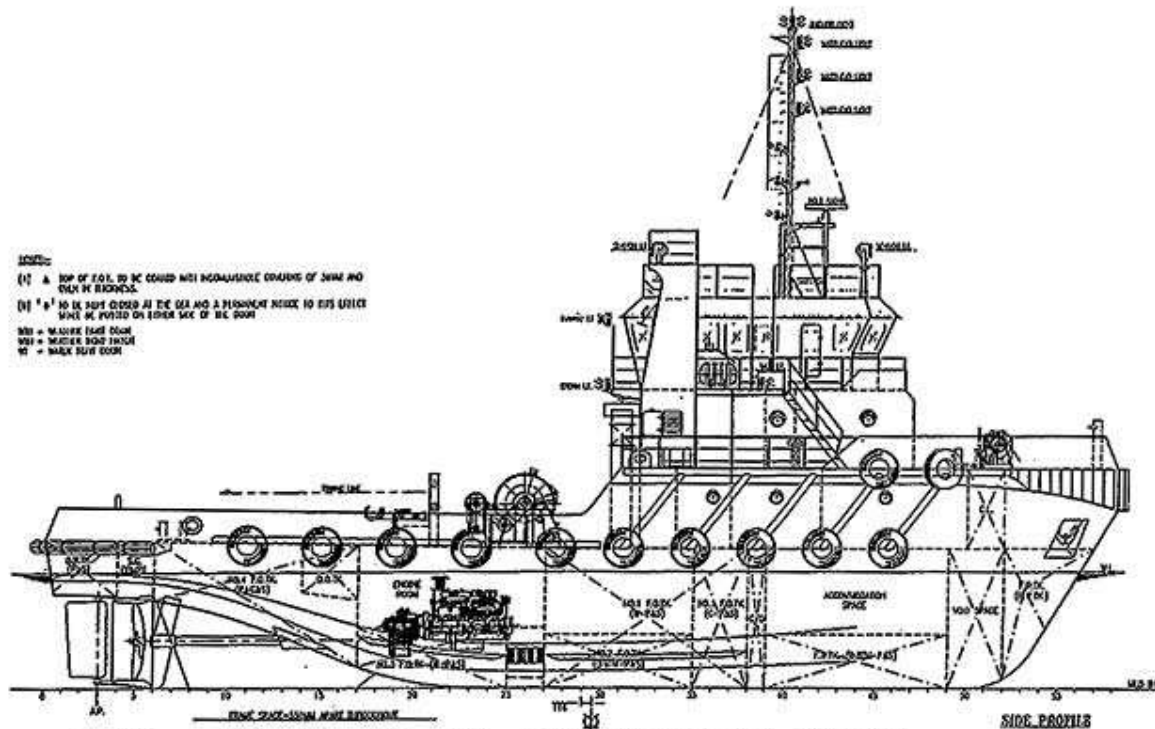

SIDE PROFILE

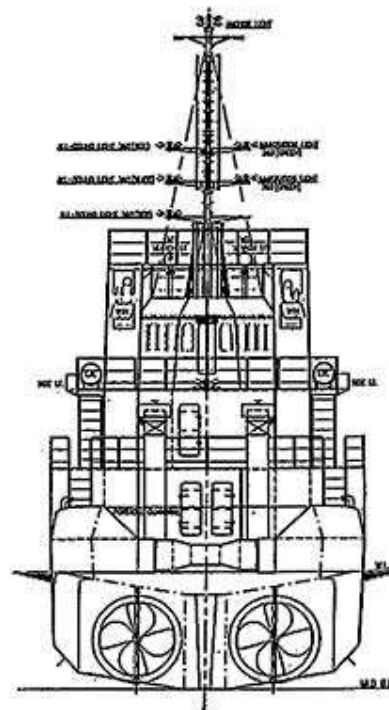

STERN VIEW

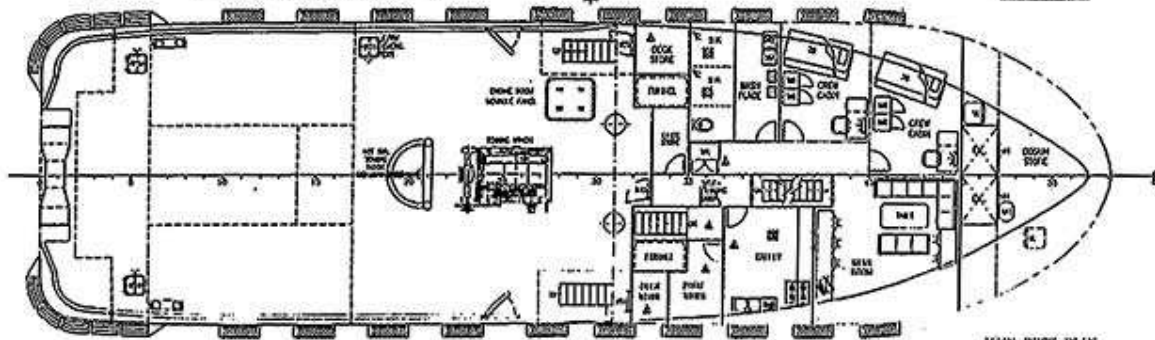

MAIN DECK PLAN

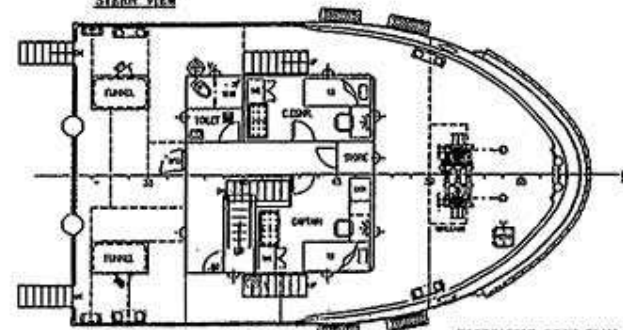

FORECASTLE DECK PLAN

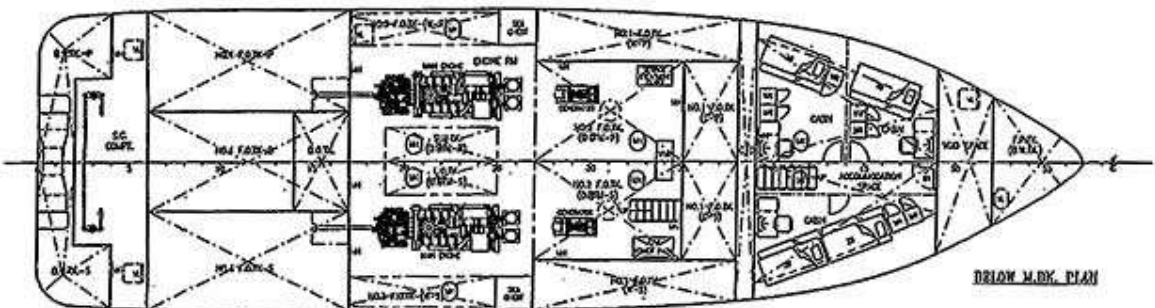

DRIVE M.O.M. PLAN

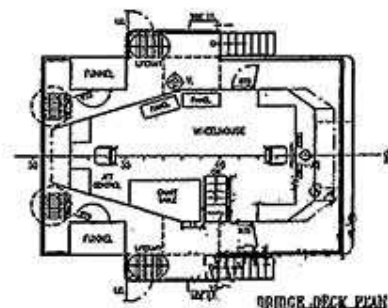

BRIDGE DECK PLAN

PRINCIPAL PARTICULARS :-

L.O.A.	32.00M (104.98FT)
L.B.P.	29.23M (95.91FT)
BREADTH MID	9.14M (30.00FT)
DEPTH MID	4.20M (13.78FT)
DESIGNED DRAUGHT	3.50M (11.48FT)
DESIGN SPEED	AUT. 11 KNOTS
COMPLEMENT	14 MEN
MAIN ENGINE	CUMMINS KTA50-M2
	1600HP/1800RPM x 2 UNITS
GEAR BOX	RENTIES WAF-66S, RATIO 5.95:1
GENERATOR	80KW x 2 UNITS
NAVIGATION AREA	UNRESTRICTED
F.O. CAPACITY	220 TONNES (approx.)
F.W. CAPACITY	32 TONNES (approx.)
D.W. CAPACITY	24 TONNES (approx.)

DATE	DESCRIPTION	BY	BY
32M TWIN SCREW TUG			
GENERAL ARRANGEMENT			
SCALE	1:100	NO. OF SHEETS	1 OF 1
DATE	11/11/75	APPROVED	SOFT
DESIGNED		CHECKED	
DATE		DATE	